

# TENNESSEE SETUP SHEET EIGHT

Name: _____		Date: _____		Event: _____	
City: _____		State: _____		Track: _____	
Track	<input type="checkbox"/> Indoor	<input type="checkbox"/> Tight	<input type="checkbox"/> Smooth	<input type="checkbox"/> Hard Packed	<input type="checkbox"/> Blue Groove
Conditions	<input type="checkbox"/> Outdoor	<input type="checkbox"/> Open	<input type="checkbox"/> Rough	<input type="checkbox"/> Loose/Loamy	<input type="checkbox"/> Dry
	<input type="checkbox"/> Wet	<input type="checkbox"/> Low Bite	<input type="checkbox"/> High Bite	<input type="checkbox"/> Med Bite	<input type="checkbox"/> Other _____
	<input type="checkbox"/> Dusty				

## Front Suspension

Toe: + 2.5°

Ride Height: 24 mm

Camber: - 3°

Caster: 0/0 (Optional Part)

Sway Bar: 2.3 mm

Piston/Oil: 7 x 55 / 45

Spring: Silver

Limiters/Droop: 95 mm

Overall Shock Length: \_\_\_\_\_

Steering Ackerman: Short

Bump Steer: Down

Camber Link: 2

Shock Location: 2 - Inside

Front Diff Fluid: 10'000

Receiver Battery Type: 1600 mAh

Center Diff Fluid: 5'000

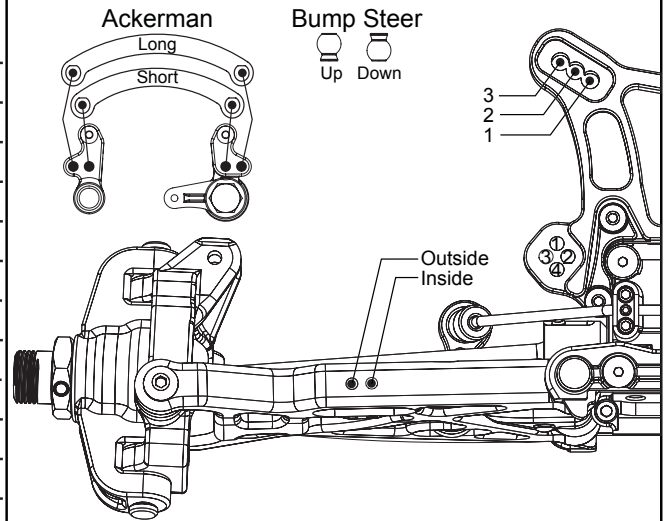

Notes: \_\_\_\_\_

\_\_\_\_\_

\_\_\_\_\_

## Rear Suspension

Toe: - 3°

Anti-Squat: 3°

Ride Height: 28 mm

Camber: - 2°

Rear Hub Spacing: All the way back

Sway Bar: 2.3 mm

Piston/Oil: 3 x 55, 3 x 56 / 25

Spring: Silver

Limiters/Droop: 106 mm

Overall Shock Length: \_\_\_\_\_

Camber Link: 4 - A

Shock Location: 1 - Inside

Rear Diff Fluid: 2'000

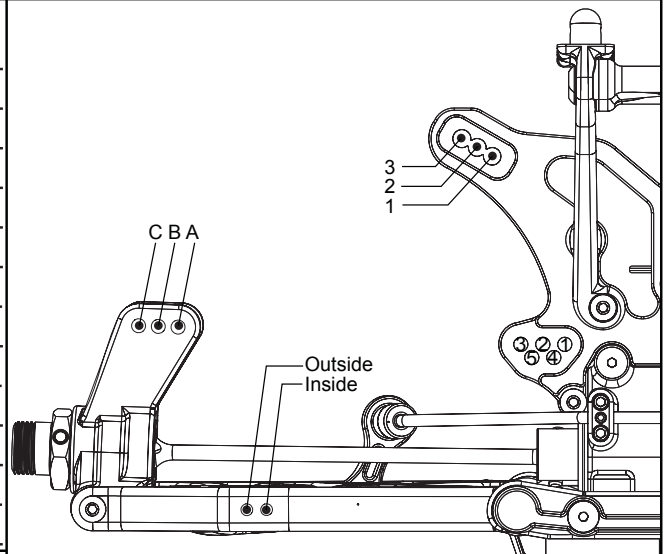

Notes: \_\_\_\_\_

\_\_\_\_\_

\_\_\_\_\_

## Engine

Engine: OS Fuel: Runner time

Glow Plug: P3 Head Clearance: \_\_\_\_\_

Pipe/Header: Mielke Gearing: \_\_\_\_\_

## Clutch

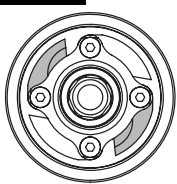

Clutch Shoes and Springs Info

\_\_\_\_\_

\_\_\_\_\_

\_\_\_\_\_

## Tires

	Type	Compound	Insert
Front:	<u>Splinter</u>	_____	_____
Rear:	<u>Splinter</u>	_____	_____
Notes:	_____		